

## Box Storage: Logging in from Mobile Apps

687 Laurie Sherrod June 21, 2023 [Box](#)

If you are on a mobile device, either from a browser or from a Box App, you should follow these instructions to log in to Clemson Box. If at any time while using a Box app you get an option "Use Single Sign On (SSO)", select that option. These instructions will be following installing the Box App on an Android phone for the first time. On other platforms, the screens should be very similar.



The first screen you see will look similar to this. Click on **LOG IN**.

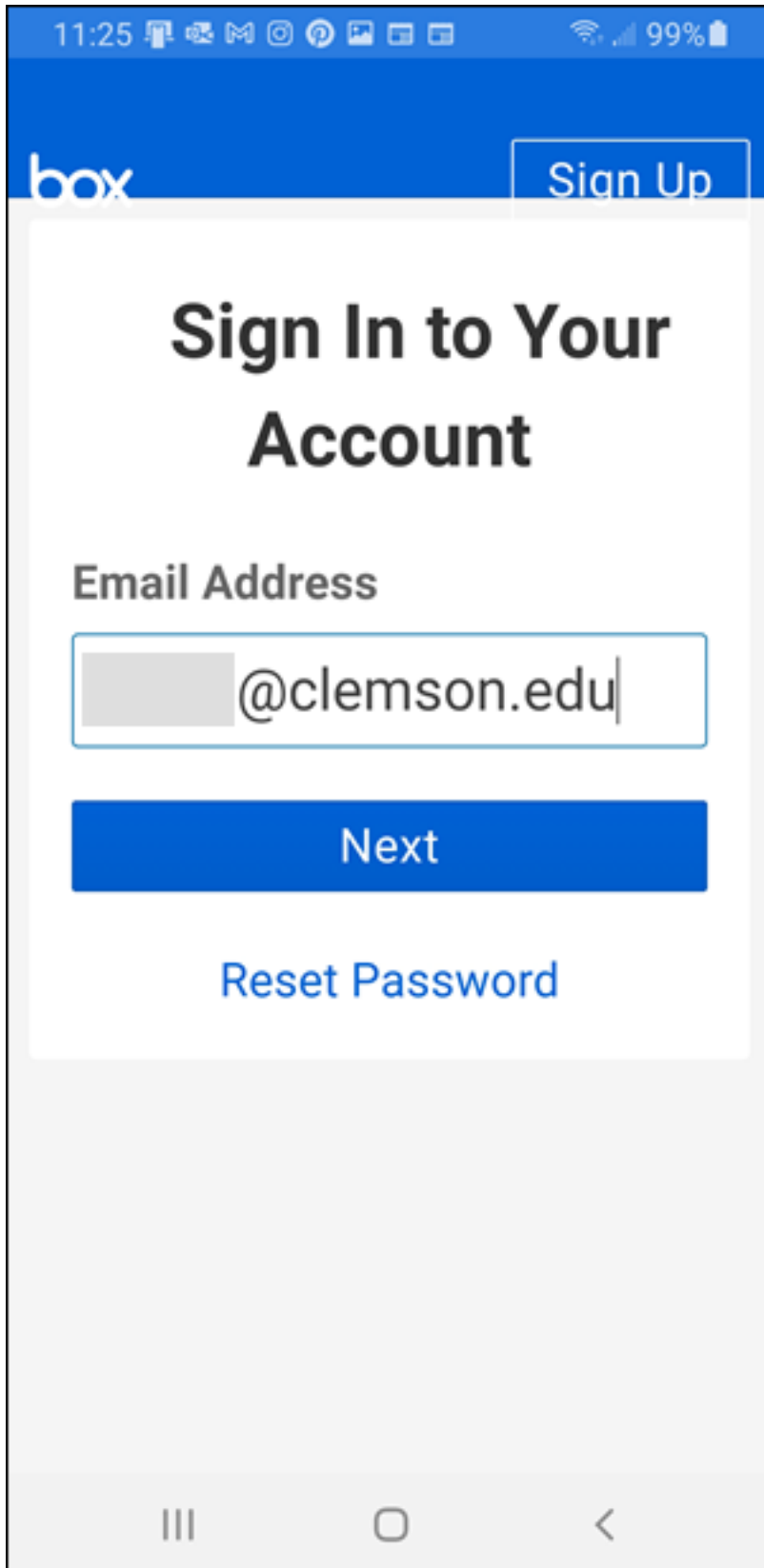

Then you will be asked for your email address. Enter your Clemson [username@clemson.edu](mailto:username@clemson.edu). Do NOT include a "g" (as in g.clemson.edu).



Next

11:25  99% 

# CLEMSON<sup>®</sup>

U N I V E R S I T Y

Username

Password

[Forgot password?](#)

**Login**

Need help? Visit the  
[CCIT Support Center](#),  
email  
[ITHELP@clemson.edu](mailto:ITHELP@clemson.edu)  
4 (864) 656-2104

III O <

Next

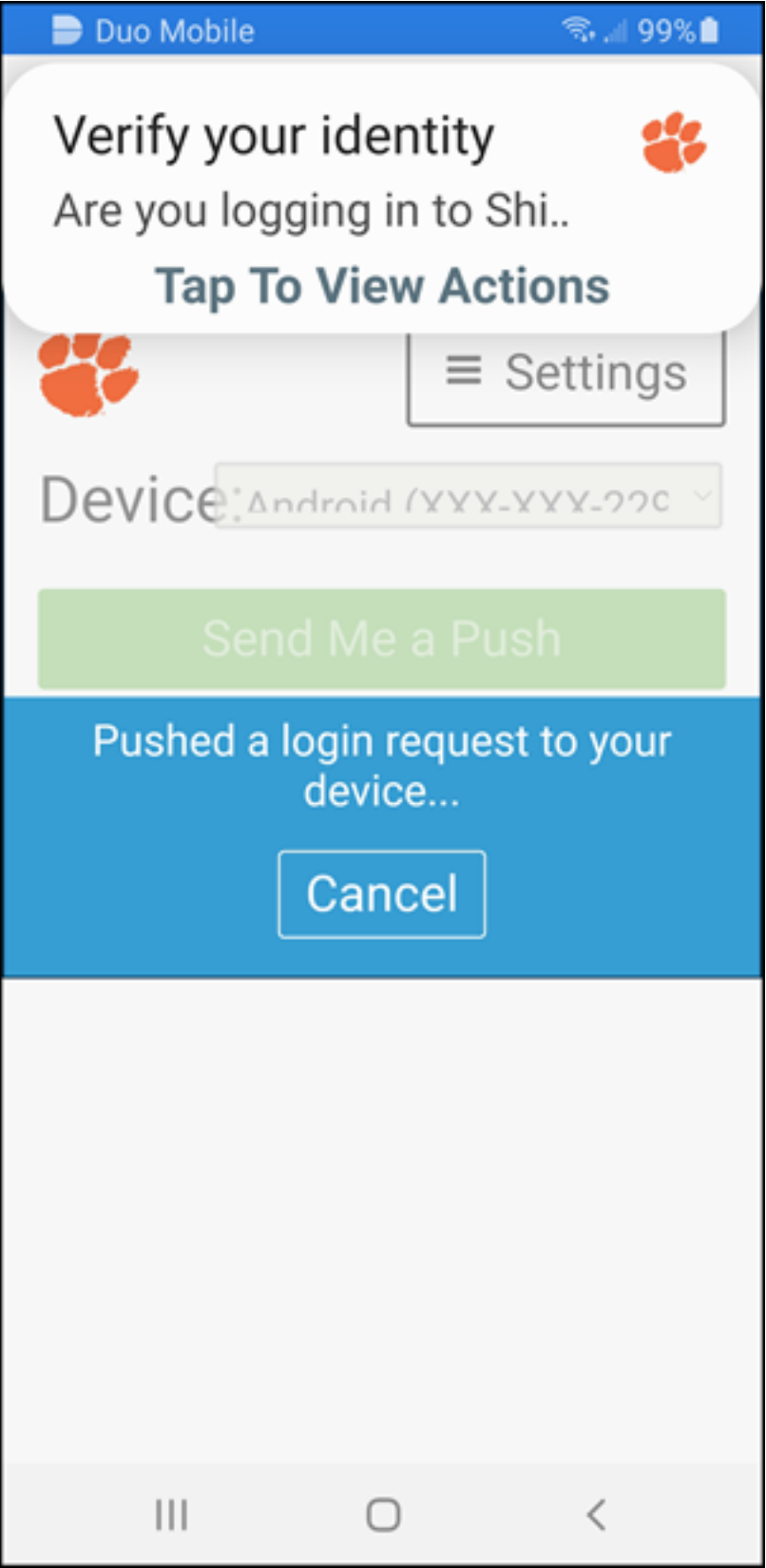

Next

11:26   99% 

# Browse



CENT

ALL FILES

OFFLI



**Pro tip:** Use your camera to scan and convert anything to PDF or to capture photos, audio, and video. Then, access them directly in Box.



ClemsonTigers

Jun 8, 20... • 84.2 KB



 DellLaptop

Jun 7, 20... • 14.3 GB



Knowledgebase

Jun 7, 202... 12.3 MB



Box Reports

Jun 1, 20... • 27.5 GB



 Browse



Now your Clemson Box account will open on your mobile device.

If you have more questions, email [ITHELP@clemson.edu](mailto:ITHELP@clemson.edu) or call 864-656-3494.

Online URL: <https://hdkb.clemson.edu/phpkb/article.php?id=687>